

5. REPORT

Background

5.1 An application for a new premises licence has been made by George Petrou in respect of The Phoenix Lounge and Bar. **Appendix 1**

5.2 **Details of the application being sought under the Premises Licence Application**

Live Music

Friday to Saturday 2000 to 2330

Recorded Music and Anything of a Similar Description to that of Live and

Recorded Music

Monday to Sunday 1200 to 0300

Late Night Refreshment

Monday to Sunday 2300 to 0000

Supply of Alcohol

Monday to Sunday 1200 to 0300

For consumption **ON** the premises

Opening Hours

Monday to Sunday 1200 to 0330

5.3 **General-all four licensing objectives**

The Licensee will ensure the use of CCTV in the premises, use of SIA door personnel at main entrance, A strict over 25 years old(age) entry policy. Signs displayed in the premises to advice clients of their responsibilities when leaving the bar.

5.4 **Crime and Disorder**

The Licensee will ensure:

- Use of CCTV, logged and recorded system
- Signs up in the bar of a 'No Drugs' on the premises, all matters reported to the Police
- On busy nights SIA personnel at the main door. Anybody who is drinking heavily will be spoken to and a cab called to take them home as not to cause nuisance in the streets.

5.5 **Public Safety**

The Licensee will ensure:

- All drinking will take place inside the premises (No drinking outside the bar). If a client wants to smoke outside they will have to leave their drink inside otherwise they will be asked to leave.
- Anybody who seems drunk or under the influence of other substances will be refused entry/service and asked politely to leave.

5.6 Public Nuisance

The Licensee will ensure:

- CCTV monitoring, recording, SIA Personnel.
- Anybody who is drinking heavily will be spoken to and a cab called to take them home as not to cause nuisance in the streets.

5.7 Child Protection

We have a zero entry to minors on the premises. Anybody who looks under age will be asked for identification and a number of questions to determine their age (this is due to the number of fake ID's available on the internet)

6. RELEVANT REPRESENTATIONS (CONSULTATION) Responsible authorities:

6.1 Comments of Metropolitan Police

Have made a representation to this application **Appendix 2**

6.2 Comments of Regulatory Services:

Environmental Health

Have made a representation to this application, which has not been agreed upon.
Appendix 3

Licensing Authority

Have made representation to this application- **Appendix 4**

Commercial Environmental Health & Trading Standards

Have not made a representation to this application

6.3 London Fire and Civil Defence Authority

Have not made a representation to this application

6.4 Planning Services

Have not made a representation to this application

6.5 Comments of Child Protection Agency or Nominee

Have not made a representation to this application

7.0 Interested Parties

Letters of representation has been received against this application **Appendix 4.**

8.0 Financial Comments

The fee applicable for this application was **£190.00.**

APPENDIX 1 – APPLICATION

WK/333169
LN 0000



HARINGEY COUNCIL
LICENSING
RECEIVED
22 SEP 2015

Application for a premises licence to be granted
under the Licensing Act 2003

PLEASE READ THE FOLLOWING INSTRUCTIONS FIRST

Before completing this form please read the guidance notes at the end of the form. If you are completing this form by hand please write legibly in block capitals. In all cases ensure that your answers are inside the boxes and written in black ink. Use additional sheets if necessary.

You may wish to keep a copy of the completed form for your records.

I MR GEORGE PETROU
(Insert name(s) of applicant)

apply for a premises licence under section 17 of the Licensing Act 2003 for the premises described in Part 1 below (the premises) and I/we are making this application to you as the relevant licensing authority in accordance with section 12 of the Licensing Act 2003

Part 1 - Premises Details

Postal address of premises or, if none, ordnance survey map reference or description			
THE PHOENIX BAR AND LOUNGE 2 QUEENS PARADE BOUNDS GREEN LONDON			
Post town	LONDON	Postcode	N11 2DN

Telephone number at premises (if any)	0208881 4440
Non-domestic rateable value of premises	£ ?

Part 2 - Applicant Details

Please state whether you are applying for a premises licence as

Please tick as appropriate

- a) an individual or individuals * please complete section (A)
- b) a person other than an individual *
 - i. as a limited company please complete section (B)
 - ii. as a partnership please complete section (B)
 - iii. as an unincorporated association or please complete section (B)
 - iv. other (for example a statutory corporation) please complete section (B)
- c) a recognised club please complete section (B)

- d) a charity please complete section (B)
- e) the proprietor of an educational establishment please complete section (B)
- f) a health service body please complete section (B)
- g) a person who is registered under Part 2 of the Care Standards Act 2000 (c14) in respect of an independent hospital in Wales please complete section (B)
- ga) a person who is registered under Chapter 2 of Part 1 of the Health and Social Care Act 2008 (within the meaning of that Part) in an independent hospital in England please complete section (B)
- h) the chief officer of police of a police force in England and Wales please complete section (B)

* If you are applying as a person described in (a) or (b) please confirm:

Please tick yes

I am carrying on or proposing to carry on a business which involves the use of the premises for licensable activities; or

I am making the application pursuant to a

statutory function or

a function discharged by virtue of Her Majesty's prerogative

(A) INDIVIDUAL APPLICANTS (fill in as applicable)

Mr <input checked="" type="checkbox"/>	Mrs <input type="checkbox"/>	Miss <input type="checkbox"/>	Ms <input type="checkbox"/>	Other Title (for example, Rev)	
Surname			First names		
PETROU			GEORGE		
I am 18 years old or over				<input checked="" type="checkbox"/> Please tick yes	
Current postal address if different from premises address		62 MARYLAND ROAD WOOD GREEN			
Post town	LONDON			Postcode	NR2 5AN
Daytime contact telephone number			07898283953		
E-mail address (optional)		gpetrou1@yahoo.co.uk.			

SECOND INDIVIDUAL APPLICANT (if applicable)

Mr <input type="checkbox"/>	Mrs <input type="checkbox"/>	Miss <input type="checkbox"/>	Ms <input type="checkbox"/>	Other Title (for example, Rev)	
Surname			First names		
I am 18 years old or over				<input type="checkbox"/>	Please tick yes
Current postal address if different from premises address					
Post town		Postcode			
Daytime contact telephone number					
E-mail address (optional)					

(B) OTHER APPLICANTS

Please provide name and registered address of applicant in full. Where appropriate please give any registered number. In the case of a partnership or other joint venture (other than a body corporate), please give the name and address of each party concerned.

Name
Address
Registered number (where applicable)
Description of applicant (for example, partnership, company, unincorporated association etc.)
Telephone number (if any)
E-mail address (optional)

Part 3 Operating Schedule

When do you want the premises licence to start?

DD MM YYYY

1	9	1	0	2	0	1	5
---	---	---	---	---	---	---	---

If you wish the licence to be valid only for a limited period, when do you want it to end?

DD MM YYYY

--	--	--	--	--	--	--	--

N/A.

Please give a general description of the premises (please read guidance note 1)

BAR IS POSITIONED ABOVE TGF PIZZA (2 QUEEN'S PARADE) ON A MEZZANINE LEVEL. ENTRANCE TO THE BAR IS IN BETWEEN TGF PIZZA AND P. SPYROU & CO CHARTERED ACCOUNTANTS. UPON ENTRY THERE ARE STEPS LEADING TO THE MAIN AREA TO THE BAR WHERE THERE IS SEATING FOR APPROX 40 CLIENTS. THE BAR ITSELF IS SITUATED TO THE FAR LEFT HAND CORNER. A CORRIDOR ON THE RIGHT HAND SIDE LEADS TO A KITCHEN TO THE LEFT AND A LADIES & GENTS TOILETS (2ND & 3RD DOORS). TO THE END OF THE CORRIDOR IS THE FIRE ESCAPE LEADING TO THE REAR AREA OF THE PREMISES.

If 5,000 or more people are expected to attend the premises at any one time, please state the number expected to attend.

40-60

What licensable activities do you intend to carry on from the premises?

(Please see sections 1 and 14 of the Licensing Act 2003 and Schedules 1 and 2 to the Licensing Act 2003)

Provision of regulated entertainment

Please tick any that apply

- a) plays (if ticking yes, fill in box A)
- b) films (if ticking yes, fill in box B)
- c) indoor sporting events (if ticking yes, fill in box C)
- d) boxing or wrestling entertainment (if ticking yes, fill in box D)
- e) live music (if ticking yes, fill in box E)
- f) recorded music (if ticking yes, fill in box F)
- g) performances of dance (if ticking yes, fill in box G)
- h) anything of a similar description to that falling within (e), (f) or (g) (if ticking yes, fill in box H)

Provision of late night refreshment (if ticking yes, fill in box I)

Supply of alcohol (if ticking yes, fill in box J)

In all cases complete boxes K, L and M

A * NOT APPLICABLE *

Plays Standard days and timings (please read guidance note 6)			Will the performance of a play take place indoors or outdoors or both – please tick (please read guidance note 2)	Indoors	<input type="checkbox"/>
Day	Start	Finish		Outdoors	<input type="checkbox"/>
				Both	<input type="checkbox"/>
Mon				Please give further details here (please read guidance note 3)	
Tue					
Wed			State any seasonal variations for performing plays (please read guidance note 4)		
Thur					
Fri			Non standard timings. Where you intend to use the premises for the performance of plays at different times to those listed in the column on the left, please list (please read guidance note 5)		
Sat					
Sun					

B * NOT APPLICABLE *

Films Standard days and timings (please read guidance note 6)			Will the exhibition of films take place indoors or outdoors or both – please tick (please read guidance note 2)	Indoors	<input type="checkbox"/>	
Day	Start	Finish		Outdoors	<input type="checkbox"/>	
Mon				Please give further details here (please read guidance note 3)		
Tue						
Wed			State any seasonal variations for the exhibition of films (please read guidance note 4)			
Thur						
Fri			Non standard timings. Where you intend to use the premises for the exhibition of films at different times to those listed in the column on the left, please list (please read guidance note 5)			
Sat						
Sun						

C * NOT APPLICABLE *

Indoor sporting events Standard days and timings (please read guidance note 6)			Please give further details (please read guidance note 3)
Day	Start	Finish	
Mon			
Tue			State any seasonal variations for indoor sporting events (please read guidance note 4)
Wed			
Thur			Non standard timings. Where you intend to use the premises for indoor sporting events at different times to those listed in the column on the left, please list (please read guidance note 5)
Fri			
Sat			
Sun			

D * NOT APPLICABLE *

Boxing or wrestling entertainments Standard days and timings (please read guidance note 6)			Will the boxing or wrestling entertainment take place indoors or outdoors or both – please tick (please read guidance note 2)	Indoors	<input type="checkbox"/>
Day	Start	Finish		Outdoors	<input type="checkbox"/>
				Both	<input type="checkbox"/>
Mon				Please give further details here (please read guidance note 3)	
Tue					
Wed			State any seasonal variations for boxing or wrestling entertainment (please read guidance note 4)		
Thur					
Fri			Non standard timings. Where you intend to use the premises for boxing or wrestling entertainment at different times to those listed in the column on the left, please list (please read guidance note 5)		
Sat					
Sun					

E

Live music Standard days and timings (please read guidance note 6)			Will the performance of live music take place indoors or outdoors or both – please tick (please read guidance note 2)		Indoors <input checked="" type="checkbox"/>
					Outdoors <input type="checkbox"/>
					Both <input type="checkbox"/>
Day	Start	Finish	Please give further details here (please read guidance note 3)		
Mon	N/A	N/A	NONE		
Tue	N/A	N/A			
Wed	N/A	N/A	State any seasonal variations for the performance of live music (please read guidance note 4)		
Thur	N/A	N/A	NONE		
Fri	8PM	11.30PM	Non standard timings. Where you intend to use the premises for the performance of live music at different times to those listed in the column on the left, please list (please read guidance note 5)		
Sat	8PM	11.30PM	NONE		
Sun	N/A	N/A			

F

Recorded music Standard days and timings (please read guidance note 6)			Will the playing of recorded music take place <u>indoors or outdoors or both</u> – please tick (please read guidance note 2)	Indoors	<input checked="" type="checkbox"/>
Day	Start	Finish		Outdoors	<input type="checkbox"/>
Mon	12 PM	3 AM	Please give further details here (please read guidance note 3)	Both	<input type="checkbox"/>
Tue	12 PM	3 AM		<u>NONE</u>	
Wed	12 PM	3 AM		State any seasonal variations for the playing of recorded music (please read guidance note 4)	
Thur	12 PM	3 AM		<u>NONE</u>	
Fri	12 PM	3 AM		Non standard timings. Where you intend to use the premises for the playing of recorded music at different times to those listed in the column on the left, please list (please read guidance note 5)	
Sat	12 PM	3 AM		<u>NONE</u>	
Sun	12 PM	3 AM			

G * NOT APPLICABLE *

Performances of dance Standard days and timings (please read guidance note 6)			Will the performance of dance take place indoors or outdoors or both – please tick (please read guidance note 2)	Indoors	<input type="checkbox"/>
Day	Start	Finish		Outdoors	<input type="checkbox"/>
Mon			Please give further details here (please read guidance note 3)	Both	<input type="checkbox"/>
Tue					
Wed			State any seasonal variations for the performance of dance (please read guidance note 4)		
Thur					
Fri			Non standard timings. Where you intend to use the premises for the performance of dance at different times to those listed in the column on the left, please list (please read guidance note 5)		
Sat					
Sun					

H

<p>Anything of a similar description to that falling within (e), (f) or (g) Standard days and timings (please read guidance note 6)</p>			<p>Please give a description of the type of entertainment you will be providing</p> <p>RECORDED MUSIC & LIVE MUSIC</p>		
Day	Start	Finish	<p>Will this entertainment take place indoors or outdoors or both - please tick (please read guidance note 2)</p>	Indoors	<input checked="" type="checkbox"/>
Mon	12PM	3AM		Outdoors	<input type="checkbox"/>
Tue	12PM	3AM	<p>Please give further details here (please read guidance note 3)</p>		
Wed	12PM	3AM	<p><u>NONE</u></p>		
Thur	12PM	3AM	<p>State any seasonal variations for entertainment of a similar description to that falling within (e), (f) or (g) (please read guidance note 4)</p>		
Fri	12PM	3AM	<p><u>NONE</u></p>		
Sat	12PM	3AM	<p>Non standard timings. Where you intend to use the premises for the entertainment of a similar description to that falling within (e), (f) or (g) at different times to those listed in the column on the left, please list (please read guidance note 5)</p>		
Sun	12PM	3AM	<p><u>NONE</u></p>		

I

Late night refreshment Standard days and timings (please read guidance note 6)			Will the provision of late night refreshment take place indoors or outdoors or both – please tick (please read guidance note 2)	Indoors	<input checked="" type="checkbox"/>
Day	Start	Finish		Outdoors	<input type="checkbox"/>
Mon	12PM		Please give further details here (please read guidance note 3) DRINKS & SNACKS (HOT BEVERAGES & ALCOHOL) .	Both	<input type="checkbox"/>
Tue	12PM				
Wed	12PM		State any seasonal variations for the provision of late night refreshment (please read guidance note 4) <u>NONE</u>		
Thur	12PM				
Fri	12PM		Non standard timings. Where you intend to use the premises for the provision of late night refreshment at different times, to those listed in the column on the left, please list (please read guidance note 5) <u>NONE.</u>		
Sat	12PM				
Sun	12PM				

J

Supply of alcohol Standard days and timings (please read guidance note 6)			Will the supply of alcohol be for consumption – please tick (please read guidance note 7)	On the premises	<input checked="" type="checkbox"/>
Day	Start	Finish		Off the premises	<input type="checkbox"/>
Mon	12PM	3AM	State any seasonal variations for the supply of alcohol (please read guidance note 4) <u>NONE</u>	Both	<input type="checkbox"/>
Tue	12PM	3AM			
Wed	12PM	3AM			
Thur	12PM	3AM		Non standard timings. Where you intend to use the premises for the supply of alcohol at different times to those listed in the column on the left, please list (please read guidance note 5) <u>NONE</u>	
Fri	12PM	3AM			
Sat	12PM	3AM			
Sun	12PM	3AM			

State the name and details of the individual whom you wish to specify on the licence as designated premises supervisor:

Name	SOTIRIS JAKES
Address	70 MARYLAND ROAD WOOD GREEN LONDON
Postcode	N22 5AN
Personal licence number (if known)	LN/000011817
Issuing licensing authority (if known)	HARINGEY COUNCIL

K

Please highlight any adult entertainment or services, activities, other entertainment or matters ancillary to the use of the premises that may give rise to concern in respect of children (please read guidance note 8).

NONE

L

Hours premises are open to the public Standard days and timings (please read guidance note 6)			State any seasonal variations (please read guidance note 4)
Day	Start	Finish	<p><u>NONE</u></p> <p><u>Non standard timings. Where you intend the premises to be open to the public at different times from those listed in the column on the left, please list (please read guidance note 5)</u></p> <p><u>NONE</u></p>
Mon	12 PM	3 AM 3:30 AM	
Tue	12 PM	3 AM 3:30 AM	
Wed	12 PM	3 AM 3:30 AM	
Thur	12 PM	3 AM 3:30 AM	
Fri	12 PM	3 AM 3:30 AM	
Sat	12 PM	3 AM 3:30 AM	
Sun	12 PM	3 AM 3:30 AM	

M Describe the steps you intend to take to promote the four licensing objectives:

a) General - all four licensing objectives (b, c, d and e) (please read guidance note 9)

THE USE OF CCTV IN THE PREMISES, USE OF SIA DOOR PERSONNEL AT THE MAIN ENTRANCE. A STRICT OVER 25 YEARS OLD (AGE) ENTRY POLICY. SIGNS UP IN THE PREMISES TO ADVISE CLIENTS OF THEIR RESPONSIBILITY WHEN LEAVING THE BAR.

b) The prevention of crime and disorder

USE OF CCTV - LOGGED & RECORDED SYSTEM. SIGNS UP IN THE BAR OF A NO DRUGS ON THE PREMISES - AND ALL MATTERS REPORTED TO THE POLICE. ON BUSY NIGHTS SIA PERSONNEL AT THE MAIN DOOR. ANY BODY WHO IS DRINKING HEAVILY WILL BE SPOKEN TO AND A CAR CALLED TO TAKE THEM HOME SO THAT THEY DON'T BECOME A NUISANCE ON THE STREETS

c) Public safety

FIRSTLY ALL DRINKING WILL TAKE PLACE INSIDE THE PREMISES (NO DRINKING OUTSIDE THE BAR). IF A CLIENT WANTS TO ~~SMOKE~~ SMOKE OUTSIDE THEY WILL HAVE TO LEAVE THEIR DRINK INSIDE OTHERWISE THEY WILL BE ASKED TO LEAVE. ANYBODY WHOM SEEMS DRUNK OR UNDER THE INFLUENCE OF OTHER SUBSTANCES WILL BE REFUSED ENTRY / SERVICE AND ASKED POLITELY TO LEAVE.

d) The prevention of public nuisance

CCTV MONITORING / RECORDING / SIA PERSONNEL. ANYBODY WHO IS DRINKING HEAVILY WILL BE SPOKEN TO AND A CAR CALLED TO TAKE THEM HOME SO THAT THEY DON'T BECOME A NUISANCE ON THE STREET.

e) The protection of children from harm

WE HAVE A ZERO ENTRY TO MINORS ON THE PREMISES. ANYBODY WHO LOOKS UNDER AGE WILL BE ASKED FOR IDENTIFICATION AND A NUMBER OF QUESTIONS TO DETERMINE THEIR AGE (THIS IS DUE TO THE NUMBER OF FAKE I.D.'S AVAILABLE ON THE INTERNET).

Checklist:

Please tick to indicate agreement

- I have made or enclosed payment of the fee.
- I have enclosed the plan of the premises.
- I have sent copies of this application and the plan to responsible authorities and others where applicable.
- I have enclosed the consent form completed by the individual I wish to be designated premises supervisor, if applicable.
- I understand that I must now advertise my application.
- I understand that if I do not comply with the above requirements my application will be rejected.

IT IS AN OFFENCE, LIABLE ON SUMMARY CONVICTION TO A FINE NOT EXCEEDING LEVEL 5 ON THE STANDARD SCALE, UNDER SECTION 158 OF THE LICENSING ACT 2003, TO MAKE A FALSE STATEMENT IN OR IN CONNECTION WITH THIS APPLICATION.

Part 4 – Signatures (please read guidance note 10)

Signature of applicant or applicant’s solicitor or other duly authorised agent (see guidance note 11). If signing on behalf of the applicant, please state in what capacity.

Signature	
Date	
Capacity	

For joint applications, signature of 2nd applicant or 2nd applicant’s solicitor or other authorised agent (please read guidance note 12). If signing on behalf of the applicant, please state in what capacity.

1st & ONLY APPLICANT

Signature	
Date	22/09/15
Capacity	MANAGER

Contact name (where not previously given) and postal address for correspondence associated with this application (please read guidance note 13)

GEORGE PETROU – ADDRESS
62 MARYLAND ROAD
WOOD GREEN

Post town	LONDON	Postcode	N22 5AN
Telephone number (if any)	07535699580 / 07535699580.		
If you would prefer us to correspond with you by e-mail, your e-mail address (optional)			
gprou1@yahoo.co.uk.			

Notes for Guidance

1. Describe the premises, for example the type of premises, its general situation and layout and any other information which could be relevant to the licensing objectives. Where your application includes off-supplies of alcohol and you intend to provide a place for consumption of these off-supplies, you must include a description of where the place will be and its proximity to the premises.
2. Where taking place in a building or other structure please tick as appropriate (indoors may include a tent).
3. For example the type of activity to be authorised, if not already stated, and give relevant further details, for example (but not exclusively) whether or not music will be amplified or unamplified.
4. For example (but not exclusively), where the activity will occur on additional days during the summer months.
5. For example (but not exclusively), where you wish the activity to go on longer on a particular day e.g. Christmas Eve.
6. Please give timings in 24 hour clock (e.g. 16:00) and only give details for the days of the week when you intend the premises to be used for the activity.
7. If you wish people to be able to consume alcohol on the premises, please tick 'on the premises'. If you wish people to be able to purchase alcohol to consume away from the premises, please tick 'off the premises'. If you wish people to be able to do both, please tick 'both'.
8. Please give information about anything intended to occur at the premises or ancillary to the use of the premises which may give rise to concern in respect of children, regardless of whether you intend children to have access to the premises, for example (but not exclusively) nudity or semi-nudity, films for restricted age groups or the presence of gaming machines.
9. Please list here steps you will take to promote all four licensing objectives together.
10. The application form must be signed.
11. An applicant's agent (for example solicitor) may sign the form on their behalf provided that they have actual authority to do so.
12. Where there is more than one applicant, each of the applicant or their respective agent must sign the application form.
13. This is the address which we shall use to correspond with you about this application.

PREMISES LAYOUT - THE PHOENIX BAR & COUNCIL

REAR AREA
OF PREMISES.
(CAR PARKING &
BIN STORES).

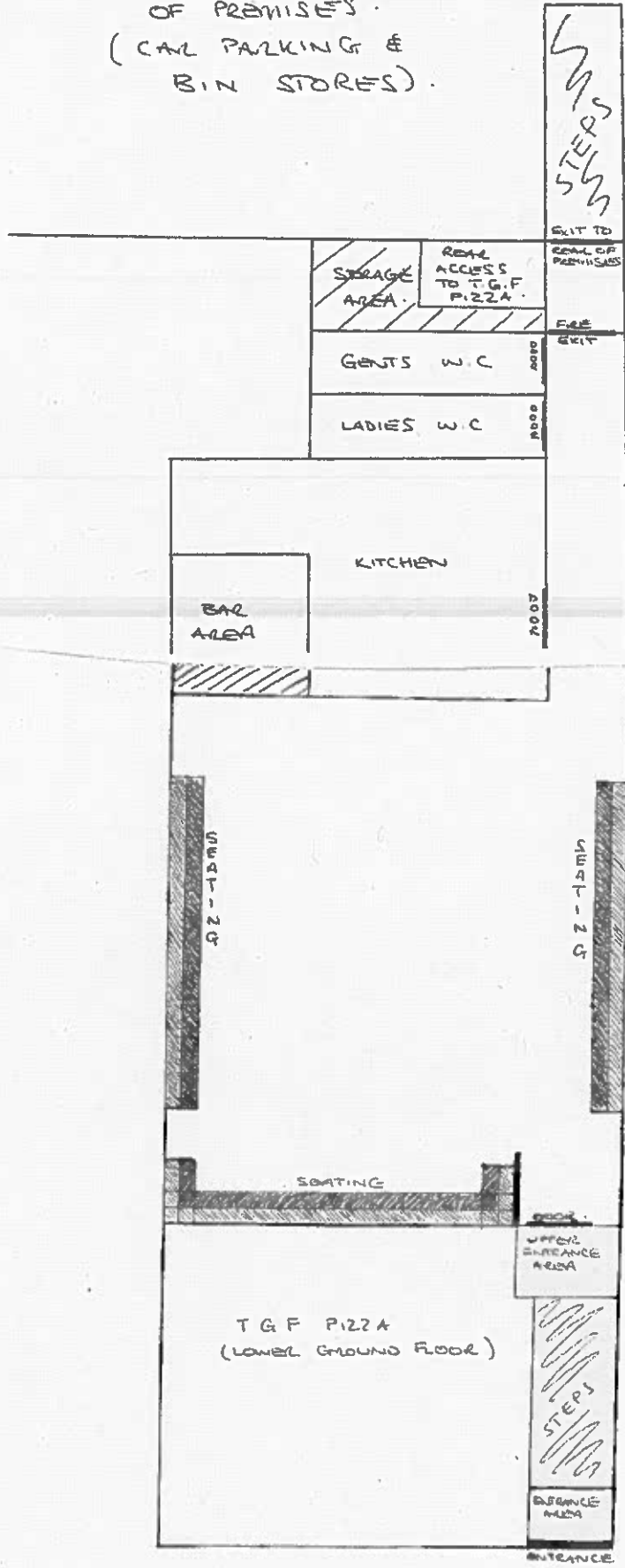

APPENDIX 2 – METROPOLITAN POLICE REPRESENTATION



**METROPOLITAN
POLICE**

Working together for a safer London

POLICE REPRESENTATION

Name and address of premises:

The Phoenix Bar & Lounge

Type of Application: New Premises Licence.

I wish to make representation on the following:

- Prevention of crime and disorder

If this application were granted in full or part, I would recommend the following alterations be made to the licence conditions. I also suggest that additional conditions be attached to the licence, as set out below, to further promote the licensing objectives.

	Current Conditions	Recommendation
1	CCTV System will be installed.	<p>A digital CCTV system to be installed in the premises.</p> <p>Cameras must be sited to observe the entrance doors from both inside and outside.</p> <p>Cameras on the entrances must capture full frame shots of the heads and shoulders of all people entering the premises i.e. capable of identification.</p> <p>Cameras must be sited to cover all areas to which the public have access including any outside smoking areas.</p> <p>Provide a linked record of the date, time of any image.</p> <p>Provide good quality images - colour during opening times.</p>

		<p>Have a monitor to review images and recorded quality.</p> <p>Be regularly maintained to ensure continuous quality of image capture and retention.</p> <p>Member of staff trained in operating CCTV at venue during times open to the public.</p> <p>Digital images must be kept for 31 days. The equipment must have a suitable export method, e.g. CD/DVD writer so that Police can make an evidential copy of the data they require. Copies must be available within a reasonable time to Police on request.</p>
2		<p>A minimum of 1 S.I.A registered security staff to be present from time venue opens to the public until it closes.</p> <p>An incident log shall be kept at the premises, it will be in a hardback durable format handwritten at the time of the incident or as near to as is reasonable and made available on request to the Police, which will record the following:</p> <ul style="list-style-type: none"> (a) all crimes reported to the venue (b) all ejections of patrons (c) any complaints received (d) any incidents of disorder (e) seizures of drugs or offensive
3		

		<p>weapons (f) any faults in the CCTV system or searching equipment or scanning equipment (g) any refusal of the sale of alcohol (h) any visit by a relevant authority or emergency service.</p>
--	--	---

This is under the Protection of Children from Harm Objective.

Challenge 21 Policy Implemented:

I recommend that the following form of verification of a person's proof of age is:

- A valid passport.
- A photo driving licence
- A proof of age standard card system
- A citizen card, supported by the Home Office.

If these conditions were accepted in full I would withdraw my representation.

Officer: Mark Greaves
Licensing Officer Haringey Police

Tel: 020 3276 0150

Mark.Greaves@Met.Police.UK

Date: 14th October 2015

**APPENDIX 3 – ENVIROMENTAL HEALTH- LICENSING AUTHORITY
REPRESENTATION**

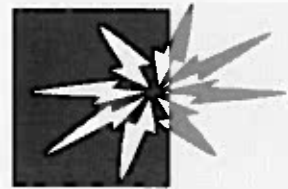

Haringey Council

Licensing Consultation

To: Licensing Officer

From: Enforcement Response Officer (Noise)

Name of Officer preparing representation: Mark Eastwood

cc: Team Leader Enforcement Response, Derek Pearce

Our Reference: WK/000333169

Date: 13th October 2015

Premises: The Phoenix Lounge and Bar, 2 Queens Parade,
Brownlow Road, Wood Green, London, N11 2DN

Type of application: New

I would like to confirm that I have considered the above proposal with regard to the prevention of public nuisance on behalf of the Enforcement Response (Noise) Team & would like to make representations to the Application

The operating schedule does not address the prevention of public nuisance from:

- airborne entertainment noise
- Structure borne noise or vibrations from entertainment
- Noise from patrons exiting the premises
- Light nuisance
- Litter nuisance

Supporting Information

The Phoenix Lounge and Bar is situated above a pizza shop on a mezzanine floor. The entrance doorway is between two businesses and opens to a flight of steps up to the bar. This position makes the premises nearer to residential properties above than a normal ground floor commercial property.

The bar itself is fairly small inside with seating for approximately 30 people.

There have been significant noise nuisance problems in the past, mainly caused by poor sound insulation and the close proximity of the business to residents due to it being elevated on a mezzanine floor. Music has also been played at an excessive volume.

Date reported & time	Subject	Observations & time	Outcome	Our Ref
9/10/15	Noise nuisance	Loud intrusive music and amplified voices. Nuisance witnessed in nearby residents property. Floorboards vibrating. Preventing sleep	Warning letter served	246393
10/10/15	Noise nuisance	Loud music and voices and amplified voices in complainants property above. Nuisance witnessed.	Noise Abatement served on the night.	334915

The proposed operating hours in regard to regulated entertainment are inappropriate due to the close proximity of residential dwellings. The construction and positioning of the bar and lounge is located between a pizza take away business on the ground floor and residential properties above. This has made the lounge bar closer to the residential properties above than for example a normal business premises located on the ground floor and therefore is wholly unsuitable for regulated entertainment.

This representation recommends that the following alterations/conditions to the operating schedule:

Patrons entering/exiting premises.

Where people queue to enter the premises a licensed door supervisor shall supervise and ensure the potential patrons behave in an acceptable manner

Signs should be displayed requesting patrons to respect the neighbours and behave in a courteous manner

Door supervisors

It is expected that busy times for such premises are most likely to be Friday and Saturday evenings, and therefore we would require SIA door supervisors be on duty from 21:00 hrs until close of business.

When the premises turn out, a licensed door supervisor shall supervise patrons and ensure they leave in a prompt and courteous manner, respecting the neighbours.

A licensed door supervisor will be positioned on the exit door to ensure, as far as reasonably practical, that patrons do not leave drinks.

Prevention of Nuisance from Odour

All ventilation and extraction systems shall be correctly maintained and regularly serviced to ensure that it is operating efficiently and with minimal disturbance to neighbours arising from odour.

Prevention of nuisance from light

Illuminated external signage shall be switched off when the premises is closed

Security lights will be positioned to minimise light intrusion to nearby residential premises

Structure borne noise

All speakers are mounted on anti-vibration mountings to prevent vibration transmission of sound energy to adjoining properties

Sound limits

The licensee shall ensure that no music played in the licensed premises is audible at or within the site boundary of any residential property

Outside Areas

Signs shall be displayed in the external areas/on the frontage requesting patrons to recognise the residential nature of the area and conduct their behaviour accordingly. The management must reserve the right to ask patrons to move inside the premises or leave if it is felt that they could be disturbing neighbours

Plant and machinery

All plant and machinery is correctly maintained and regularly serviced to ensure that it is operating efficiently and with minimal disturbance to neighbours arising from noise

Dealing with complaints

A complaints book will be held on the premises to record details of any complaints received from neighbours. The information is to include, where disclosed, the complainant's name, location, date time and subsequent remedial action undertaken. This record must be made available at all times for inspection by council officers

Regular four monthly liaison meetings will be held where specifically requested by residents to enable neighbours to raise concerns about any aspect of the licensed activities

Operating hours

That regulated entertainment ceases at 23:00 hrs

Reason: Significant recent intrusion of music and amplified voice noise amounting to a noise nuisance into residents properties above the bar have resulted in a warning letter and Noise abatement Notice being served on subsequent nights.

Should the application come before a committee hearing and if the committee wishes to allow regulated entertainment after 23:00hrs, we would wish for the following conditions be applied:

Prevention of nuisance from noise / vibration

All doors and windows will remain closed during the licensed regulated entertainment activities or in any event after 11pm. The entrance door will be fitted with a self-closing device and staff required to ensure that it is not propped open. A member of staff shall be made responsible to ensure the door is opened for as brief a period as possible. Where necessary adequate and suitable mechanical ventilation should be provided to public areas

**APPENDIX 4 – ENVIROMENTAL HEALTH- LICENSING AUTHORITY
REPRESENTATION**

Shah Noshaba

From: Barrett Daliah
Sent: 20 October 2015 09:21
To: Shah Noshaba; Anderson Chanel
Subject: The Phoenix Bar & Lounge, 2 Queens Parade Brownlow Road Bounds Green London N11 2DN - LICENSING AUTHORITY REPRESENTATION.

Dear Sir,

We are making representation in regard to your application for premises licence for the premise at 2 Queens Parade Brownlow Road Bounds Green London N11 2DN.

In determining what conditions are appropriate, it will be necessary to consider the individual circumstances of the premises, including:-

- The nature and style of the venue,
- The activities being conducted there,
- The location, and,
- Anticipated clientele.

We have considered the application for a premises licence that has been submitted and consider the hours being requested will have an adverse impact on the prevention of public nuisance for nearby residents.

Our records show that the premises has made use of Temporary event notices recently which have lead to complaints of noise nuisance from the venue. With this in mind the hours being applied for should be curtailed to:

Regulated entertainment (in all forms) – to cease at 23.00 Monday to Sunday.
Supply of alcohol – to cease 10.30pm Monday to Sunday.

We would particularly like to remind applicants of their existing legal obligations regarding:-

- Irresponsible Drinks Promotions,
 - Selling alcohol to a person who is drunk, and
 - Underage sales
- Fire Risk Assessments.

Licensees and premises supervisors are also reminded of the offence of selling alcohol to a person who is drunk, and to ensure that all staff are aware of the consequences.

Licensing Authority

Haringey
LONDON

Haringey Council
6th Floor, 10 Station Road, London, N22 7TR

T. 020 8489 8232
M. 07870 154 126
daliah.barrett@haringey.gov.uk

www.haringey.gov.uk
[twitter@haringeycouncil](https://twitter.com/haringeycouncil)
facebook.com/haringeycouncil

Please consider the environment before printing this email.

APPENDIX 5 – LETTER OF REPRESENTATION FROM ‘OTHER PARTIES’

Shah Noshaba

From: [redacted]
Sent: 19 October 2015 20:22
To: Licensing
Cc:
Subject: Licencing Act 2003- re: The Phoenix Bar & Lounge, 2 Queens Parade Brownlow Road
Bounds Green London N11 2DN
Attachments: IMG_20151019_200841~2.jpg

To whomever it may concern,

I am writing regarding the above mentioned bar and lounge and to plea AGAINST granting the owner the licence that has been applied for.

I would like to request to be notified of the outcome of this matter at hand and if I would also be present at any future hearings in order for me to pledge my case in person. Please find below my details as well as the details of the premises of which the licence is being applied for and details as to why they should NOT be granted the licence with regards to past incidents regarding noise nuisance by multiple previous owners.

My Name: [redacted]

My Residential Address: [redacted] Bounds Green, London

Postcode:

As it is quite clear from my address, [redacted] from which the noise will be coming/has been coming from.

Contact Number: [redacted]

Application Number: Unknown

Name of Licensee : Mr GEORGE PETROU

Name of Premises (if applicable): THE PHOENIX BAR & RESTAURANT

Premises Address (where the Licence will take effect)

2 QUEENS PARADE BOUNDS GREEN LONDON

Postcode: N11 2DN

REASONS FOR DENYING LICENCE FOR PHOENIX BAR & LOUNGE:

I live in [redacted] and have reported many incidents involving noise nuisance over the past two years. The purpose of my contact with you is to oppose the application from the above owner for a Provision of Late Night Refreshment, Supply of Alcohol licence, Playing of Recorded 12pm - 3am Music - Monday to Sunday performance of live Music - Friday and Saturday 8pm - 11:30pm licence.

The music coming from the [redacted] premises has been unbearable at times and the high level of music can continue and prolong till early hours of the morning. As a working Optician, I do work on Saturdays from early morning to evening and for me to be kept awake till 2am is neither fair nor healthy. I have been suffering from an unsteady cycle of sleep and insomnia due to the constant loud music emanating from the premises due to the inconsiderate nature of the previous owners. I myself have been residing at my above address for the whole duration of my life and I still remember my Mother calling the council for over a decade now to make them aware of the situation and the fact that she at the time had girls living in the same flat who were studying and still at school and that their sleep was being disrupted every weekend and on several occasions weekdays as well. Now that I am working, it should not make it any less of a problems that I cannot get to sleep until 2am for at least three days in the week because the council have granted a licence for the below bar to play music at a 'low level', which as we both know that promise has not and most likely will not be upheld. My parents are both above 60 years old, my father reaching 70 and I think it is fair to say that they deserve their rest more than I do.

We have had several owner of the below premises promising us that the music level shall be kept at a low; some owners have asked us to contact them directly if the noise exceeds beyond their promised level. This has been attempted in the past, where I have been in direct contact with the owner to lower the noise however after a few weeks of interaction with them I have eventually faced the phone being rudely put down on me, dismissal of my request to lower the music and refusal to cooperate with me. I have then been resulted to contact the council repeatedly to complain about the noise. Below I have listed just a few of the reference numbers and dates of the numerous noise complaints I have made over the past year with regards to the Phoenix Club:

22/05/2015 T985463 @ 22:52pm

24/05/2015 T987640 @ 22:51pm

31/05/2015 T992172 @ 00:38am

05/06/2015 T996964 @ 23:57pm chased up with ref T997055

06/06/2015 T998693 @ 23:36pm

02/10/2015 T1091140 @ 23:14pm

03/10/2015 T1092312 @ 21:55pm

04/10/2015 T1092431 @ 12:00am

09/10/2015 T1096153 @ 21:05pm

It is not fair that I have been kept awake till the early hours of the morning with music pounding through my walls. It is not fair that I have to hear the music all the way up into the f of my flat to my bedroom till the early hours of the morning. It is not fair that do not look forward to coming back home any more from work on Friday as I anticipate the music to start raging through my floor at 9pm. It is not fair that I cannot have a quiet night in just as how others are entitled to. I don't think anyone would tolerate this way of life.

The licence for alcohol that they are appealing and applying for has also affected us, the residents. Due to high consumption of alcohol it has been witnessed that men come to urinate near the minicab office next to the bar, which is also happens to be an entrance for us residents to get to our flats. I do not appreciate having to walk through someone else's filth on my way to work early in the morning on a Saturday after they have had their Friday night at the bar. Alcohol as we all known can instigate violence and antisocial behaviour as well as noise from the bar goers themselves and this within itself is another noise nuisance as well as danger to my family. People have been witness loitering and drinking at ridiculous hours of the night and day. As a young woman myself, it is unfortunate that I have to be twice as cautious coming back home even at a reasonable hour of 9pm from work as there are already drunken individuals roaming around the entrance to my residence. Even though my gender should NOT be a factor however it is and I have been approached SEVERAL times by drunken males loitering around the area and emerging from the bar itself. It is NOT FAIR that I have to fear my own safety and quite literally run and fumble through the entrance to my OWN residence in the fear that I could be attacked or sexually assaulted by a drunken individual. I do not appreciate that I have to live in fear around an area I have resided in for 24 years of my life just because a bar and lounge would like to open their antisocial and unreasonable services in a residential area.

I hope that my points will be taken into consideration. I appreciate that businesses need to go on however not at the expense of our safety, health and peace within our own homes within which we have resided far longer than they may have even proposed the idea of running their businesses.

PLEASE NOTE: I DO NOT WISH MY NAME, ADDRESS OR PERSONAL CONTACT INFORMATION TO BE PUBLISHED WHEN THESE REPRESENTATIONS ARE MADE A PUBLIC RECORD.

Please also find attached a letter from the noise nuisance team of Haringey Council after one of the team had come to witness the noise levels at our residence dated 09/10/2015.

Thanking you,

Yours Faithfully,

**This email has been scanned by the Symantec Email Security.cloud service.
For more information please visit <http://www.symanteccloud.com>**

Anderson Chanel

From: Licensing
Subject: FW: Licensing Act 2003 - The Phoenix Bar & Lounge - 2 Queens Parade Bounds Green N11 2DN

To: licensing@haringey.gov.uk

From: [REDACTED]

Subject: Licensing Act 2003 - The Phoenix Bar & Lounge - 2 Queens Parade Bounds Green N11 2DN

Date: Mon, 12 Oct 2015 21:07:53 +0100

Dear Sir/Madam

Please consider the below in relation to representations about why a Licence should NOT be granted at the above premises.

Kindly acknowledge receipt and advise when this matter is going to be heard and whether I can be present at the hearing to speak in person.

Personal Details

Name: [REDACTED]
Address: [REDACTED]
Postcode: [REDACTED]
Tel: [REDACTED]

Application Number: Unknown
Name of Licensee : Mr GEORGE PETROU
Name of Premises (if applicable): THE PHOENIX BAR & RESTAURANT

Premises Address (where the Licence will take effect)
2 QUEENS PARADE BOUNDS GREEN LONDON
Postcode: N11 2DN

REASONS FOR REPRESENTATIONS UNDER THE FOUR LICENSING OBJECTIVES:

The Prevention of Public Nuisance

I am [REDACTED] 2 Brownlow Road Bounds Green N11 2DN. This is the flat directly above the premises which an application has been made for a licence for Provision of Late Night Refreshment, Supply of Alcohol, Playing of Recorded 12pm - 3am Music - Monday to Sunday performance of live Music - Friday and Saturday 8pm - 11:30pm.

I oppose the grant of this licence on the grounds of it causing a public nuisance. My tenants live in the flat directly above and have complained about the loud music being played without any consideration for the residential premises above.

The noise interferes with the quality of sleep of the tenants and they are denied the quiet enjoyment of their premises. They are unable to watch TV in peace, or entertain their friends. The tenants are students and require solitude to be able to concentrate on their studies and are disturbed by the increased undesirable elements this licence brings.

I have had tenants move out of my flat in the past because it is easier for them to find a quieter place to live than to go through all this hassle about complaining to the Council, calling the out of hours noise abatement team, etc.

The Council has granted this licence previously, and are aware of the increased noise levels which generate complaints from the residential areas above. It is beyond my comprehension why the Council continues to entertain the grant of such a licence at this premises, without any consideration of the continual misery it causes the residents of the flats above.

The occupants of this restaurant has changed a couple of times and each time the residents of the flats are put through the misery and requirement of making repeated representations and complaints. This is very unfair! We do have better things to do with our time other than being forced to make applications to the Council to prevent this licence from being granted time and time again.

It is unfair that each time loud music is played at a late hour, the residents have to call the out of hours noise team, to attend the premises at ridiculous hours to monitor the noise levels, before something can be done to stop the music.

This is a time when people are meant to be resting, not forced to make complaints in order to fulfil a basic human need of undisturbed sleep! It is against the tenants human rights that they are subjected to this Inhumane behaviour. My tenants are kept awake by the loud music and find it difficult to get up in the morning due to the lack of sleep.

My neighbour has evidence they can present showing the number of times this disturbance has occurred going back over two years. Fortunately for me, I do not live at the premises, so I am unable to provide corroborating evidence however, the Council is fully aware of the complaints they have received.

I would like to put it to the members of the committee considering the grant of this licence and ask how they would feel if they were a resident of the flats above this type of establishment where they are harassed and subjected to loud music and undesirable louts hanging around outside of your residence in the early morning hours.

The Prevention of Crime and Disorder

The grant of this licence encourages crime and disorder, because people leaving the premises are at a high risk of being intoxicated. Men do at present urinate outside the front entrance to the flats (near the mini cab office) and make the place smell and it is unhygienic and disgusting to be have no alternative but to walk through other people's urine.

There is an increase of undesirable people hanging around late at night and into the early hours of the morning around the entrances to the flats. They also cause a disturbance.

Public Safety

The safety of the residents upstairs is compromised by the increase of undesirable types of people hanging around the entrances of the flats.

I would like you to consider that once someone gets past the entrance doors, it would be very easy for someone to slip in behind a resident and attack them out of view of the general public. You need to see a physical photo of the area and the entrances of the residential area to realise how dangerous and easily this can be accomplished.

The Protection of Children from Harm - Not applicable.

KINDLY NOTE: I DO NOT WISH MY NAME AND ADDRESS TO BE PUBLISHED WHEN THESE REPRESENTATIONS ARE MADE A PUBLIC RECORD.

Yours faithfully

~~XXXXXXXXXX~~

This email has been scanned by the Symantec Email Security.cloud service.
For more information please visit <http://www.symanteccloud.com>